

**ITEM 5.           ITEM FOR COMMITTEE INFORMATION – TRAFFIC TREATMENT –  
CARRINGTON STREET FROM WYNYARD TO MARGARET  
STREETS SYDNEY**

**TRIM RECORD NO:   2015/081426**

**RECOMMENDATION**

It is recommended that the Committee note the following:

- (A) Reallocation of kerb space on the eastern side of Carrington Street between the points 6.2 metres and 81.6 metres north of Wynyard Street as “No Parking Route Services Buses accepted 15 Minute Limit”; and
- (B) Reallocation of kerb space on the eastern side of Carrington Street between the points 81.6 metres and 96 metres north of Wynyard Street as “Loading Zone Ticket 10am-3pm Mon-Fri, 6am-10am Sat”, “No Parking Route Services Buses accepted 15 Minute Limit at other times”;

**DECISION**

**BACKGROUND**

On 19 December 2013, the NSW Government adopted the Sydney City Centre Access Strategy (Access Strategy). The Access Strategy will deliver a fully integrated transport network in Sydney’s City Centre that puts the customer first and meets the growing transport task. It will mean more people use public transport to access the City Centre and it will change the way people move around within it.

The Access Strategy considers all transport modes and demonstrates how light rail, buses, trains, ferries, cars, taxis, pedestrians and cyclists will interact in the heart of Sydney. The Access Strategy also provides a clear direction for how all the different transport modes will work together in the Sydney CBD to reduce congestion, provide for future growth and improve the customer experience.

The Sydney City Centre Bus Plan (SCCBP) forms part of a suite of transport improvements associated with the Access Strategy and includes:

- New dedicated Bus Lanes, Bus Stops and shelters;
- Modifying kerbs and footpaths, line markings and medians; and
- Removing and relocating some taxi ranks, Loading Zones and on-street parking spaces.

The SCCBP aims to:

- Provide a more efficient bus network that is easier for customers to use and understand;
- Create bus corridors within the CBD that improve links to key destinations and improve connectivity with other transport modes; and

- Relocate existing bus routes on George Street to enable delivery of the CBD Light Rail.

The SCCBP will be delivered by Roads and Maritime Services (RMS), in conjunction with Transport for New South Wales (TfNSW) and the City of Sydney.

### **COMMENTS**

The kerb space on the eastern side of Carrington Street between Wynyard and Margaret Streets is generally signposted as “Bus Zone”, “Loading Zone” and “3P Ticket”.

Carrington Street between Wynyard and Market Streets is identified in the Access Strategy as a key bus corridor. The bus corridor includes “No Stopping”, “Bus Zone” and “Bus Lane 6am-8pm Mon-Fri 10am-6pm Sat” and off-peak “Loading Zones” on the eastern side of Castlereagh Street.

Where possible, loading, taxi and parking for people with disabilities will be distributed to neighbouring streets, contained within the proposed changes for the bus and cycleway plans.

### **CONSULTATION**

The RMS publically exhibited the Review of Environmental Factors (REF) from 23 June to 25 July 2014. Notification of the REF included a letterbox drop to 36,000 properties, a dedicated website, a drop-in centre and visits and meetings with 200 stakeholders within the affected area.

Of the 36,000 letters distributed, the RMS received 60 submissions. Of these 17 supported the proposal, 31 opposed the proposal and 12 were neutral.

Submissions opposing the proposal were concerned about the loss of loading and parking spaces, increased noise and impact to business.

Submissions supporting the proposal believed the proposal would improve public transport access to the City and reduce general traffic congestion.

Included in the consultation process, meetings were held with individual stakeholders who raised concerns about the proposals. The proposal was amended based on these concerns to better meet the needs of the community within the allowable scope of the project objectives

### **FINANCIAL**

The SCCBP is being fully funded by the NSW State Government.

### **ATTACHMENTS**

Item for Committee Information – Traffic Treatment – Carrington Street from Wynyard to Margaret Streets Sydney

Stephen Sherwin, Project Manager – Roads and Maritime Services

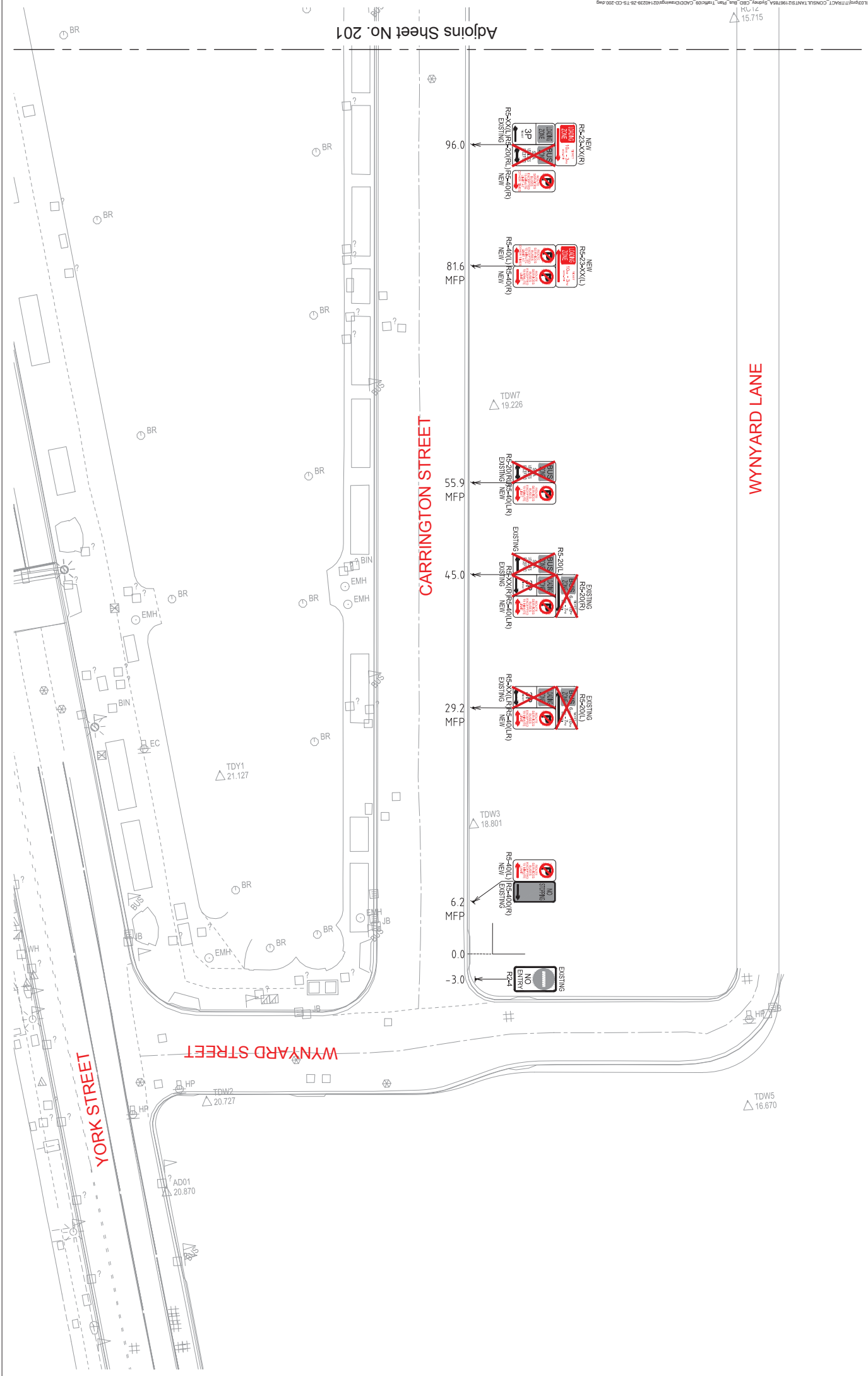

Adjoins Sheet No. 201

WYNYARD LANE

CARRINGTON STREET

Rev	Description	Date	Drawn	Checked
01	BASE FOR CONSTRUCTION		ISAIAH ILL	IBC

**PARSONS BRINCKERHOFF**  
 Level 27, Ernst & Young Centre  
 688 George Street  
 Sydney NSW 2000  
 Telephone: +61 2 9272 5100  
 Facsimile: +61 2 9272 5101  
 Email: pbr@parsonsbrinckerhoff.com.au  
 ABN 80 079 004 798

**NSW NOW**  
 The new state of business

**planners & architects**  
 landscape architects  
 project & construction managers  
 urban designers  
 transport planners  
 100 Pitt Street Sydney NSW 2000  
 Tel: (61) 2 9257 5555  
 Fax: (61) 2 9257 5556  
 Email: info@cbdalliance.com.au

**CBD ALLIANCE**  
 Project: SYDNEY CITY CENTRE BUS INFRASTRUCTURE

**TRAFFIC SIGNAGE PLAN**  
 CARRINGTON STREET  
 SHEET 1 OF 2  
 Project Number: 15-CD-200  
 Drawing Number: 15-CD-200-01  
 Date: 08.08.2014  
 Author: R.W.  
 Checker: R.W.  
 Scale: 1:500 (A1)

These designs, plans and specifications and the copyright therein are the property of TRACT CONSULTANTS PTY LTD and must not be used, reproduced or copied in any form without the written permission of TRACT CONSULTANTS PTY LTD.

